

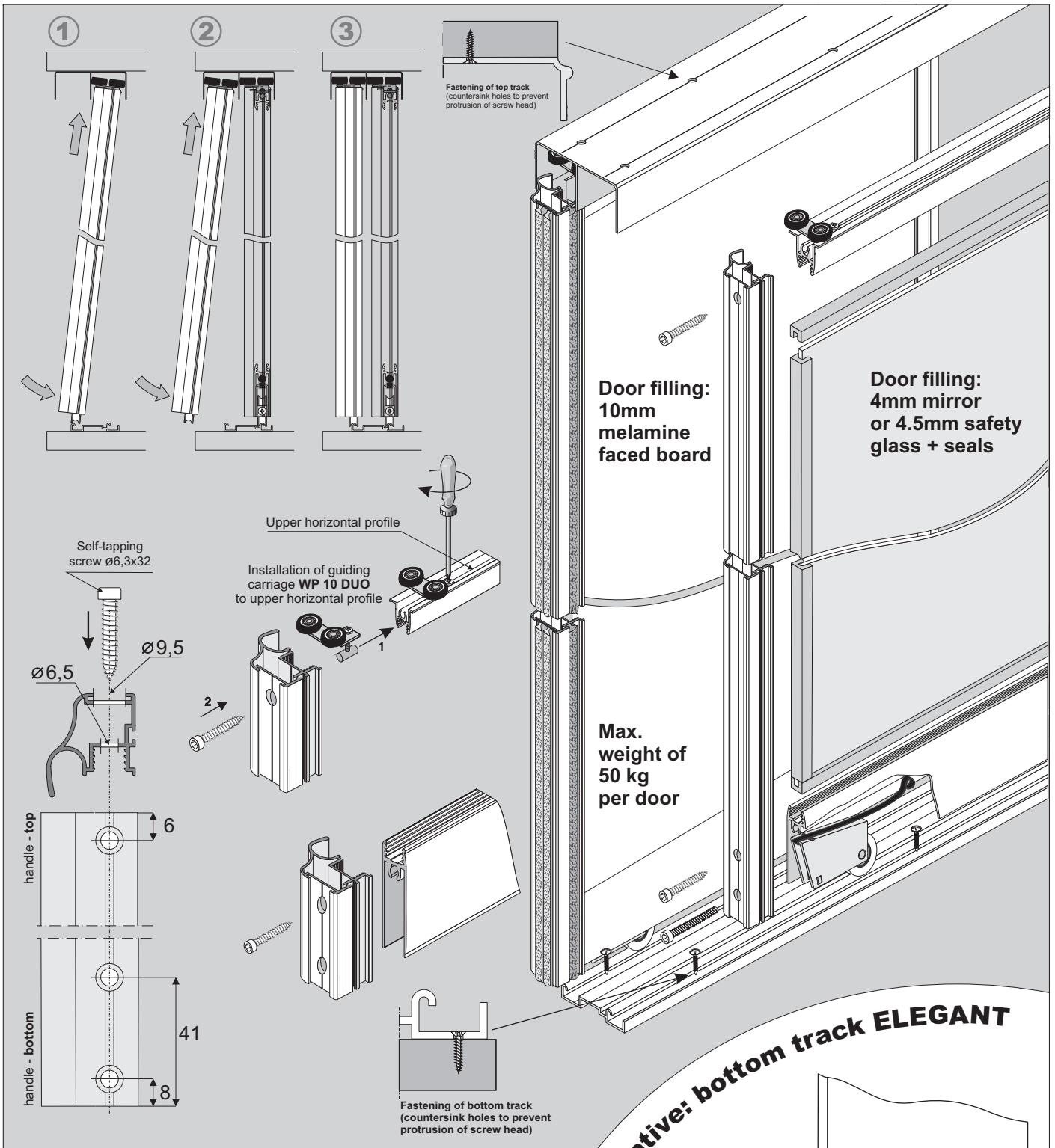

Set:
10 II

System Gemini 10

SEVROLL[®]



COMPONENTS

<p>Handle "10 II"</p> <p>Anti-dust brush (self-adhesive) 4.8mm x 13mm Brush door buffer (no glue required) 14,5mm x 4mm</p> <p>Length 2.7m</p>	<p>Top track "Gemini"</p> <p>76 mm</p> <p>Length 1.7m, 2.35m, 3m, 4.05m.</p>	<p>Bottom track "Gemini"</p> <p>53 mm</p> <p>Length 1.7m, 2.35m, 3m, 4.05m.</p>
<p>Guiding carriage "WP 10 DUO"</p> <p>Length 2.7m</p>	<p>Lower horizontal profile (A) Upper horizontal profile (B)</p> <p>Length A, B 1.7m, 2.35m, 3m.</p>	<p>Bottom carriage WD 10 C HI-TEC</p>

You must remember to purchase self-tapping screws to construct each door (4 screws per door).
When using mirror or safety glass you must also remember to purchase seals.

Alternative: bottom track ELEGANT

With "10" set you may also use bottom track *Elegant* along with bottom carriage WD 10 V HI-TEC. Fitting measurements are not affected.

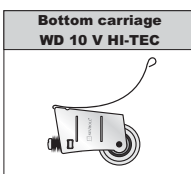

Stopper

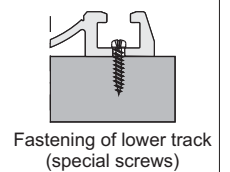

Fastening of lower track (special screws)



Dimensions of opening

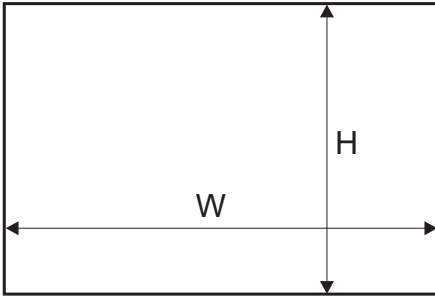

Handle length = door height

door filling - 10mm board, mirror or safety glass.

door height	- h	$h = H - 38\text{mm}$
board height	- hb	$hb = h - 60\text{mm}$
door width	- w	$w = (W - 3 \text{ mm} + Z) / N$
board width	- wb	$wb = w - 36\text{mm}$
upper horizontal profile length - U lower horizontal profile length - L		$U = L = w - 53\text{mm}$
mirror height	- hm	$hm = hb - 4\text{mm}$
mirror width	- wm	$wm = wb - 4\text{mm}$

number of doors	- N	2	3	4
total overlap	- Z	35 mm	70 mm	105 mm

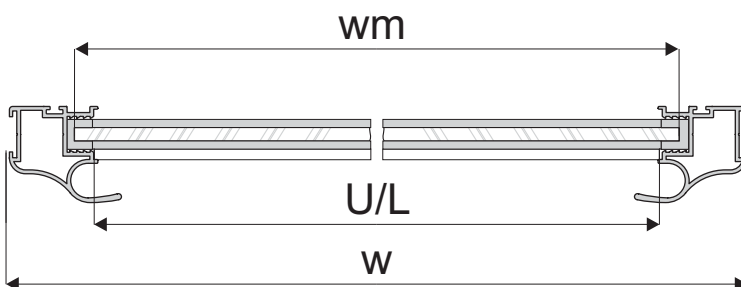
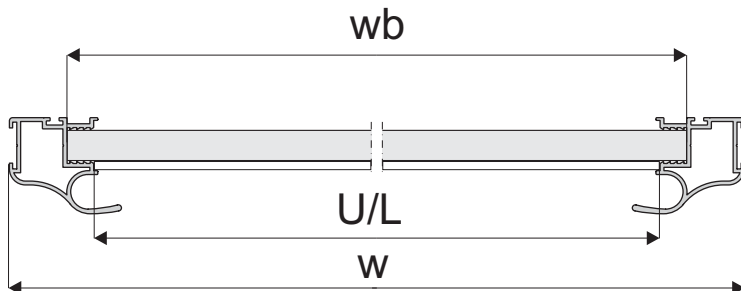

ATTENTION !

Mirror (4mm) should be used with a safety backing film. Safety glass (4.5mm) comprises of two thin layers with a film in-between. Both mirror and glass need fitting seals.

Installation method for fitting 10mm board (diag.A) and mirror or glass (diag.B)

- with handle

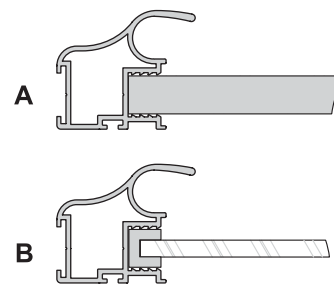

- with upper horizontal profile

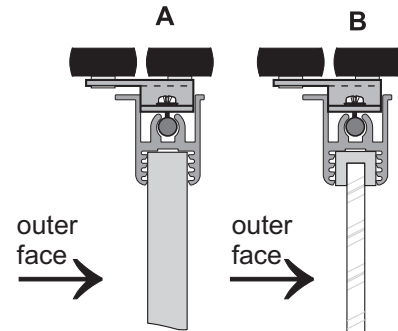

- with lower horizontal profile

